

THE BUTTERLEY CHURCHES

Together serving the communities of...

SWANWICK

Saint Andrew's Church



PENTRICH

Saint Matthew's Church

RIPLEY

All Saints Church

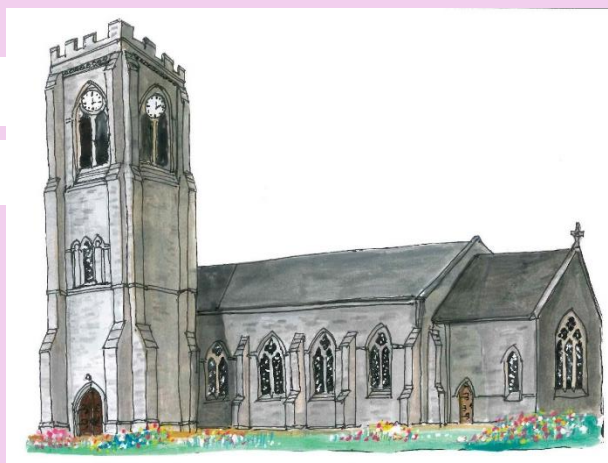

Artwork by Kevin Roberts

SWANWICK - PENTRICH 1.1 miles
PENTRICH - RIPLEY 2.3 miles
RIPLEY - SWANWICK 2.5 miles

THE BUTTERLEY CHURCHES

CONTENTS

	PAGE
Archdeacon's letter	5
Acting Area Dean's letter.....	6
Letter from the Butterley Churches	7
 1. INTRODUCTION	 8
1.1 The town of Ripley	
1.2 The village of Swanwick	
1.3 The Parish of Pentrich	
 2. OUR VISION, NEW MINISTER AND OUR SUPPORT	 9
 3. ALL SAINTS CHURCH, RIPLEY	 11
3.1 Our fellowship	
3.2 Mission and ministry	
3.3 The church and development opportunities	
3.4 Church accounts	
 4. SAINT ANDREW'S, SWANWICK	 16
4.1 Our fellowship	
4.2 Mission and ministry	
4.3 The church	
4.4 Church accounts	
 5. SAINT MATTHEW'S PENTRICH	 20
5.1 Our fellowship	
5.2 Mission and ministry	
5.3 The church	
5.4 Church accounts	
 6. ADDITIONAL INFORMATION	 23
6.1 Occasional offices	
6.2 The vicarage	
6.3 Contacts	

Archdeacon's letter

From the Archdeacon of East Derbyshire, Venerable Karen Hamblin.

Welcome!

Thank you for taking the time to read this profile and my prayer is that you will know God's call on your life as you read.

These three churches, set in different contexts, are on a journey of discovering how to work well together for the sake of the Kingdom, and are making good progress. There is a willingness to learn from one another and support each other which of itself models something of the life of Christ amongst them given their diversity. Formal next steps will need to include considering the possibility of helpful and positive pastoral re-organisation to legally express their unity, followed by the lifting of suspension.

As you will see, opportunities for mission are plenty and there is a willingness to engage with community that could lead to all sorts of exciting possibilities, including the development of new worshipping communities. As such, this is very much a place for an enabling leader who enjoys seeing people equipped and released into all that God has for them.

I have been particularly struck by the prayerfulness of these churches through the vacancy and their desire to hear God and respond to his call is so encouraging. They understand that the Kingdom of God really is good news for all and are looking for a leader who can help them step into the realisation of that, both through established ministries, but also through the exploration of new opportunities together.

It would be lovely to hear from you and if you would appreciate a conversation my contact details are on the back page.

We will be praying for you as you consider whether to apply for this post.
With every blessing,

Karen

Ven Karen Hamblin.

**From the Acting Area Dean of the South East Derbyshire Deanery.
The Venerable Andie Brown**

Dear Friends,

Thank you for considering applying for this exciting and fulfilling ministry. I know these parishes well as I live in the parish in retirement, and my wife worships at All Saints regularly and I join her when I'm available. For this reason I am recusing myself from the shortlisting and interviews, and the Assistant Area Dean, Dawn, will meet you at interview.

The S.E. Deanery reaches from Swanwick in the north down to Long Eaton and Sawley in the south, and includes one of Derby Diocese's major conurbations in Ilkeston. As an area it has the whole range of demographic profiles that can be found in this varied diocese of Derby. There are areas of urban and rural social deprivation, post-industrial settings alongside affluent and picture postcard pretty villages.

The parishes encompass this range as well, which makes for a wide, fascinating and never dull ministry for the incumbent.

Supporting you in this ministry is an excellent "Home Team" in the parish (read about them in this profile), three engaged congregations and two PCCs learning to work together and looking forward to a closer unity. There is also a well-attended, open and welcoming Deanery Clergy Chapter. We meet monthly to share issues we encounter in our ministries, for shared wisdom and common experiences, for prayer for the world and each other - and we are looking forward to welcoming the new Vicar of Ripley and Priest-in-Charge of Swanwick and Pentrich.

With my prayerful best wishes,



The Venerable Andie Brown
Acting Area Dean of the South East Derbyshire Deanery.

From the Butterley Churches:
All Saints Church, Ripley.
Saint Andrew's Church, Swanwick.
Saint Matthew's Church, Pentrich.

Post of Vicar of Ripley and Priest-in-Charge of Swanwick and Pentrich Churches.

To all prospective applicants for the post.

We welcome you and thank you!

We are absolutely delighted that you have paused to look at our profile at this significant moment in the life of our churches.

We are looking for a leader and pastor with fresh ideas who will work with us so that together we can discover new possibilities with God in these days. Someone who can enable us to grow in our worship, discipleship and numbers to serve God in our parishes and beyond, influencing our communities with a generous faith, courageous hope and the life-giving love of Jesus.

This is an exciting opportunity to explore how the three Butterley Churches can support one another as we learn to work more closely together, and to see how we can respond to the different communities we serve. It will need energy and drive from us all to prayerfully pursue God's purposes and discern the way forward for our churches.

If you feel God's calling to know more, then do contact us, our details are at the end of the profile. We would love to meet you to have a chat or come to one of our services where you will find a warm welcome.

Our prayers are with you as you read this – please also pray for us.

From the PCC's of the Butterley Churches.

1. INTRODUCTION

The Butterley Churches group of two benefices was formed nearly three years ago: one is All Saints Parish Church, in the town of Ripley; the other is comprised of Saint Andrew's Church, in the village of Swanwick and Saint Matthew's Church, in the village of Pentrich. We are learning to work more closely together with a view to becoming legally linked. We are situated approximately ten miles north of Derby and within easy reach of the Peak District, the M1 and the A38.

1.1 THE TOWN OF RIPLEY

Ripley is still a market town and has a population of approximately 20,000 with 14,000 in the parish of Ripley. It is the main town in the Amber Valley area, housing the offices of Amber Valley Council and the headquarters of Derbyshire Constabulary and Fire and Rescue Service. There is a modern leisure centre, a hospital and an ambulance station nearby.

There is good primary and nursery school provision and Ripley Academy for 11 to 18 year-old students.

The housing includes private, local authority, housing association and sheltered accommodation. There are several substantial ongoing housing developments around the edge of the town. The community has a broad range of social backgrounds, incomes, attitudes and challenges.



All Saints Church, Ripley

The church is ideally situated in the centre of the town just off the Market Place. It was extended and reordered in 1999 to provide a modern flexible space for worship and ministries.

The church grounds were re-ordered sometime later and now provide a quiet oasis in the centre of the town where people can sit in pleasant surroundings during the summer. Links with businesses, schools, Amber Valley and Ripley Town Councils are very good. The church is increasingly seen as a place where people can find a warm welcome, support and a friendly face.

1.2 THE VILLAGE OF SWANWICK

Swanwick is a large village with 4,329 on the Amber Valley electoral roll. There is a good variety of local shops.

Rowthorne Care Home in the village is council run and well respected. There is also the well-known Hayes Conference Centre here which holds many Christian conferences. We are well supplied with a pre-school, primary school and two secondary schools, one of which supports children from the surrounding area who have moderate learning difficulties.

There is an on-going new build at Lily Street on the north edge of the village, expecting a total of 600 new homes. However, the current phase of the development is not within our parish.

Saint Andrew's Church, Swanwick

The church is situated at the crossroads right in the centre of the village and there are also Baptist and Methodist churches along the main road with which we have very good working relationships. Amber Valley Crematorium lies within the parish boundary and is less than 1 mile from St. Andrew's Church.



1.3 THE PARISH OF PENTRICH

St Matthew's Church is situated at the top of a hill overlooking the village of Pentrich. Pentrich is a small, picturesque village a few miles west of Swanwick and Ripley. It has an important place in history as the centre of the Pentrich Revolution or Rising of 1817, the last armed uprising in Britain and a most fascinating story.

The parish includes the settlements of Hammersmith and Lower Hartshay.

2. OUR VISION, NEW MINISTER AND OUR SUPPORT

2.1 TO BE A GROUP OF CHURCHES THAT RESPOND TO THE CALL TO:

- continue to grow in numbers and depth as disciples of Jesus through worship and prayer and to be places of relevance to families and children of today's culture where all are welcomed, purpose is found, and lives are changed as people find Jesus as Saviour.
- be an open, inclusive and diverse group of churches, and in the power of the Holy Spirit respond practically, generously and with compassion to the changing needs of our communities.
- have a presence and influence within the communities we serve through committed discipleship that is outwardly focused and devoted to bringing the love and the hope of Jesus into our parishes and beyond.

2.2 WE ARE LOOKING FOR A NEW VICAR WHO IS:

- a proactive, collaborative leader whose desire is to pursue God and His purposes through the leading of the Holy Spirit, inspiring and motivating the churches to grow in faith and discipleship to share the gospel with children, youth, adults and families.
- a person who holds worship and prayer as a priority for the church and will join with us to develop these in the life of the church, both individually and corporately.
- an approachable person with good listening and communication skills, who engages well with people of all ages and social backgrounds, willing to be an active presence both within our churches and in the communities we serve.
- a minister with the skills to be an 'enabling leader.' Someone who can work with us to build effective teams and discern new ways in which we can work more closely together as a group of churches whilst responding to the different needs of the communities we serve.
- a strategic thinker with good organisational skills who can be decisive in leading, encouraging and developing new and existing ministries in creative ways, with particular focus on working with families and young people in the mission of our churches.
- a risk taker for God. Committed to leading the mission of the churches out into the community and beyond, by inspiring and facilitating training as appropriate.

2.3 OUR SUPPORT

We have:

- a strong team of preachers and leaders consisting of four retired ministers with PTO, one associate minister – working full-time on a new Church of England initiative, so part-time, a curate in training, two readers and a lay leader.
- two united and supportive PCC's that are ambitious for God, eager for growth, willing to change and able to get things done.
- a team of volunteers supporting the administration of Swanwick and Pentrich churches who are beginning to work more closely with the administration in Ripley.
- teams taking significant responsibility for different aspects of mission and ministry. All those involved have a heart for the communities we serve, reaching seniors, children and families with the love of Jesus.
- a commitment to pray for you and the growing of the Kingdom in our churches (*and communities*).
- an open, evangelical tradition, looking to see more of the gifts and fruit of the Holy Spirit at work in our churches and communities.

This post requires an Enhanced DBS

3. ALL SAINTS CHURCH, RIPLEY

3.1 OUR FELLOWSHIP

All Saints has an open evangelical tradition committed to sharing God's love with those we serve. We are an open and inclusive church with a warm welcome to both regular and new members and those just visiting. People new to the church often speak of the kindness shown by church members in enabling them to feel comfortable and welcome on their first visit. This is very much at the heart of the mission of the church - to be a blessing to those we serve and to share the Good News of Jesus with those who use the church and with the wider communities.



We have a passion to reach the families and children in our parish and to find ways to connect and build relationships that open the door to the Kingdom of God.

We have a single morning service each Sunday at 10am, attended on average by seventy adults and six children under sixteen years of age. The service is livestreamed on Facebook which is very much appreciated by those who find it difficult to attend services. The demographic of our church congregation is more towards the over 60's. However, we do have a few young families who attend the services, particularly when the worship is band led and there is Young Church. We are blessed to have a small, talented group of musicians who lead our sung worship.

Our Sunday services follow a regular monthly pattern:

SUNDAY	TYPE OF SERVICE at 10.00am
1 st	A traditional Holy Communion service with hymns led by the organ
2 nd	An informal Family Worship service with Young Church meeting during the service. This is frequently led by a band with contemporary songs of worship.
3 rd	Morning Prayer service with anointing with oil for healing.
4 th	An informal Holy Communion service with Young Church meeting, again sometimes led with a band.
5 th	An informal Family Holy Communion service.

Most people remain after the service for fellowship and refreshments lasting very frequently as long as the service.

- In addition to the Sunday services, there is weekly Morning Prayer on Tuesday.
- At the time of the Annual General Meeting review of 2023 (held in May 2024), there were 114 people on the electoral roll of which 47 currently have Safeguarding training and DBS clearance. This is very much indicative of the number of church members willing to lead and serve to support the various ministries.
- All Saints PCC is committed to every-member ministry. There are normally twelve elected members, three Deanery Synod members, two church wardens and the vicar, who chairs the meeting. We meet approximately seven times each year commencing at 7.30pm with a time for pre-meeting prayer at 7.00pm.

- We have a dedicated group of ministry co-ordinators who lead the various mission and ministry teams and a team of vergers to assist the minister with occasional offices.
- We have a paid church administrator who works four mornings a week, Tuesday to Friday 9.30am to 12.30pm, in the church office.

3.2 MISSION AND MINISTRY

MISSION AND MINISTRY WITH CHILDREN

Squeals on Wheels

On Monday morning the church is transformed to accommodate Squeals on Wheels. This is a very successful parent/guardian toddler group which has been running for many years and meets in church weekly. Our aim is to have fun whilst bringing the word of God to these children through singing, dancing and a very short Bible story and prayer. We offer tea, juice and biscuits, and most importantly toast! We try to encourage our families to join us at church and at JAM, we would love them to be a part of the bigger church family.



Young Church

Young Church meets on the second and fourth Sundays during the 10am service. Children from 3 years upwards attend and learn more about Jesus through teaching, games and crafts. Parents are welcome to stay if they wish. We are looking to expand this ministry.

Open the Book

Open the Book is an exciting storytelling project which has been operating for many years. The team go into local primary schools and present a 10 to 15-minute scripted Bible story, which is very much enjoyed by the children.

JAM



JAM is a relatively new and exciting fresh expression of church. It meets monthly on a Saturday at 4.00pm. New and existing church families can gather to explore the Christian faith together through games, crafts, music and discussions. Families also meet for social events such as ten-pin bowling and picnics throughout the year.

A few comments when asked, 'What do you like about JAM?' were:

"We like the crafts and activities which are fun for all ages."

"Getting together with new people and learning about Jesus and God in different ways."

Saint John's Primary and Nursery Church of England School

We have a close connection with Saint John's Church School. The vicar leads the school in collective worship twice each month and there are three foundation governors. Pupils frequently visit the church for different services throughout the year and to cover parts of the school RE curriculum. Earlier this year the church contributed towards the cost of the hugely successful iSingPOP event. At the recent SIAMs Inspection, the school was found to be 'living up to its foundation as a Church school.'

Looking to the future, the headteacher said, "I hope that the new minister will be looking to engage with the school and widen the children's knowledge and experience of faith and the scriptures, make them aware of the church's role in the community and the role faith can have in their lives."

Ripley Junior and Ripley Infants Schools

We have a good relationship with these schools which has developed over several years. Each year groups come to the church for planned curriculum lessons with a minister, at different times during the year. These schools hold their Christmas celebrations in church.

MISSION AND MINISTRY WITH ADULTS AND THE WIDER COMMUNITY

Home Groups

We have three homegroups that meet fortnightly. We are in the process of rethinking homegroup provision and would welcome the wisdom and guidance of our new Vicar.

Alpha

The church is committed to running Alpha courses each year. We have just completed an Alpha course and are looking to provide a post-Alpha course for the group who want to continue together in the Autumn.

Pastoral Care

There is a small pastoral care team and an established prayer line which is contactable by telephone or by text messages.

Open Door

Open Door continues to be a successful ministry held on Friday mornings in the church, where we offer tea/coffee, home-made cakes and a listening ear. It is popular amongst older people who come to find friendship and like-minded people who enjoy each other's company.



A few comments when asked, 'What does Open Door mean to you?' were: "Open Door made me so welcome, I now come to church on Sundays." "It is warm and welcoming, meet new people, makes a lovely change from sitting at home."



Support for the Salvation Army

Although All Saints is not a food bank, we have supported the Salvation Army food bank through weekly food donations for many years.

More Generally.....

All Saints Church hosts community events throughout the year. All are well attended.

- A Remembrance Day Service in the church grounds which sees over 800 gathered, with representatives from various local organisations involved.
- Visits from the local schools to support the RE curriculum and for Christmas services.
- Civic services in collaboration with the mayors of Ripley Town Council and Amber Valley Borough Council.

- A service of Light twice a year for the bereaved.
- The switching on of the Christmas lights on the Market Place is always a big event. Last year saw hundreds of families gathered in the church to do craft work and have refreshments.
- Christmas services include Carols by Candlelight, Lunchbreak Carols, a Crib Service on Christmas Eve at 4.00pm, and midnight and morning Christmas Communion services.

MISSION THROUGH OTHER ORGANISATIONS

We tithe ten percent of our giving income to financially support the work of: Valley CiDS – a local Christian Charity; Betel - a support/rehabilitation centre on the outskirts of Derby for those with severe alcohol and drug addictions; SAT 7 and Links.

3.3 THE CHURCH AND DEVELOPMENT OPPORTUNITIES

THE CHURCH



The church was completed in the 1820's and minor alterations have taken place over the years including an extension and re-ordering which was dedicated in 1999. The nave along with the gallery has a seating capacity of approximately 250, with comfortable chairs in the nave and fixed pews in the gallery. The church, a Grade 2 listed building, is in very good condition.

The organ has been well maintained and is a good instrument. The church tower houses a full peal of eight bells and the building is heated by an efficient gas fired system. There is a modern audio-visual system and an induction loop for the hearing-impaired.

There is a dais to the east end containing a baptistry and an open space to the west end, which is used for informal gatherings and the church café. At the back of the church is a glass fronted crèche to which services can be relayed. The church office is well equipped and is located above the ground floor lobby and kitchen area.

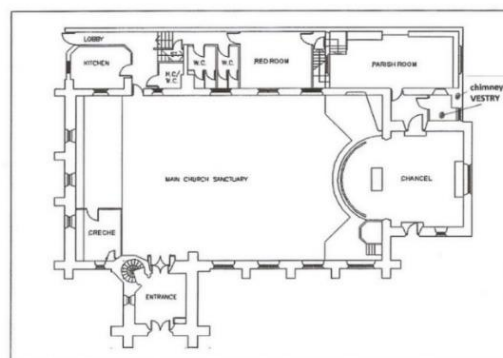

FUTURE DEVELOPMENTS

In 2006, the church purchased the old Police Station site adjacent to the church, shown on page 15, with a view to building a Church/Community Centre at the heart of the town. We sold the Church Hall site further down Moseley Street, for housing development just prior to the onset of Covid-19.

The land, along with the designated funding (£420,000), provide a tremendous opportunity for the space to be used to promote the mission and ministry of the church. We are increasingly aware of

the limitations and excessive costs, particularly during the winter months, of using the church for small group activities.

We are likely to be looking at a modest eco-friendly development, *possibly* to be a drop-in Centre where people can find a warm welcome in pleasant surroundings to either seek support or to have a coffee/tea and a chat.

A place:

- where our smaller groups and future new groups can meet.
- where families might seek support.
- to provide a safe environment for young people to meet in the evening.
- for groups within the community to meet.
- available for private hire.

It has always been our vision not only to build a new building, but to provide opportunities to build bridges between the church and the community of Ripley that we are here to serve.

Although this is an exciting project and we would naturally expect the new minister to have an interest in this development, we would not want it to distract him/her from God's *wider* calling and ministry to the churches.

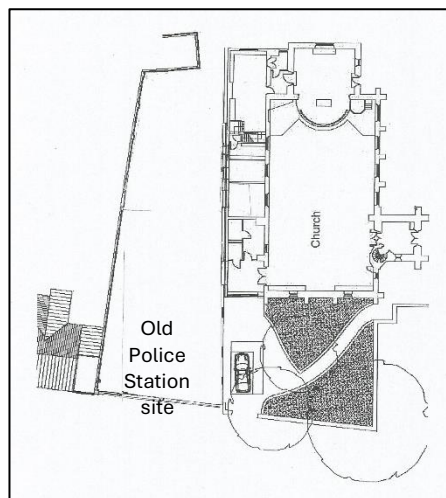

3.4 CHURCH ACCOUNT BALANCES

1 st Jan 2023	1 st Jan '23	Income	Expend	Transfers	31 st Dec '23
General Account	22,312	85,597	87,977	1,709	21,641*
Designated:					
Property (land adjacent) ¹	226,494	-	-	-	226,494 ¹
Fabric:	21,347	63	-	-	21,410
Community:	1,267	-	114	-	1,153
Totals	249.108	63	114	-	249,057
Restricted					
Charities	-	4,330	4,330	-	-
Fabric	276	317	-	-	593
Fire Safety	690	-	-	-690	-
Heating	-	375	-	-375	-
Squeals	-	399	275	-124	-
Warm Space initiative	1,250	1,931	831	-520	1,830
Youth	12,189	80	-	-	12,269
Church Project ²	412,100	9,577	-	-	421,677 ²
Totals	426,505	17,009	5,436	-1,709	436,369
TOTAL FUNDS	697,925	102,669	93,527	-	707,067

Our Diocesan Common Fund for the year ending December 2023 was £49,845 which was paid in full. All Saints Church has always paid the share in full and in the past, for a number of years, paid beyond that requested by the Diocese.

* A recent sermon series on giving, not undertaken for many years, has now seen us in credit for 2024.

¹ Estimated value of the land adjacent to the church.

² Restricted for the development of the land adjacent to the church.

4. SAINTS ANDREW'S CHURCH, SWANWICK

4.1 OUR FELLOWSHIP

St Andrew's sits at the heart of C/E doctrine, tending towards being Evangelical in its outlook yet being open to different styles of worship. Our Clergy robe for communion services and we enjoy a wide variety of traditional and more modern hymns accompanied by the organ or piano, and often the guitar. Sermons are based on biblical teaching. The all-age worship format is left to the presiding minister which means that we have enjoyed a wide variety of approaches, which we feel helps our understanding of God's work. This service is always followed by refreshments.

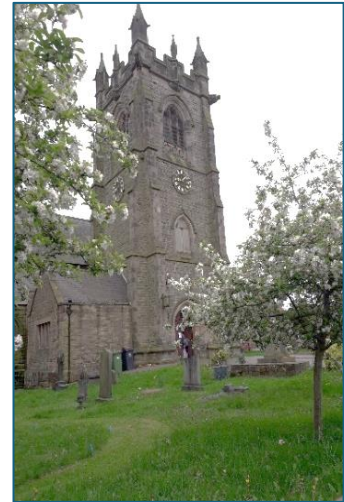

CURRENT WORSHIP PATTERN

SUNDAY	TYPE OF SERVICE at 10.30am
1 st	All Age Worship
All other	Holy Communion (with St Matthew's joining us on the 3rd, 4th and 5th)

Services on Wednesday 11am at the Old School House:

1st & 3rd Wednesdays Holy Communion and 2nd & 4th Wednesdays Morning prayer.

Average attendance is around 30-35 on a Sunday and averaging 12 on a Wednesday. There are 67 members on our church electoral roll.

We have a joint PCC with St Matthew's with 9 members from St Andrew's including: 2 church wardens, PCC Secretary, St Andrew's treasurer and a premises committee chairperson. We have an active premises committee which meets regularly and has delegated powers from the PCC. It was a difficult time with no vicar throughout Covid, but we worked together as a team which has strengthened us.

In addition, there are many support teams within the church - cleaning, general support during services, flowers and gardening.

Our mission statement is 'Living and sharing the love of Jesus.' Our aim is to build on our strong foundation and to become a more vibrant church at the heart of our community, reaching out to families including those recently moved into the village, and strengthening our connections with schools and preschool provision. We know that we must change and are willing to follow you, so that our church will still have a strong presence in Swanwick in the future.

4.2 MISSION AND MINISTRY

CHURCH GROUPS

- St. Andrew's Toddlers - term time Mondays 10 am - 11.30 am.
- Friends of Mother's Union meet once a month.
- Bell ringers - practice sessions 1st and 3rd Tuesdays at St Matthews. Bells are rung on Sundays and on other occasions. We have 6 bells, the heaviest ring of 6 in Derbyshire which are well respected for their tone. Recently we replaced the bell ropes. There is a growing team of ringers.
- 2nd Swanwick St. Andrew's Rainbows – term time Wednesdays 5pm (in 35th year)
- 2nd Swanwick St. Andrew's Brownies - term time Tuesdays 6pm (in 80th year)
- 2nd Swanwick St. Andrew's Guides - term time Thursdays 6.30pm (in 80th year)

The church is not used to its full potential - we would like to bring more people / groups through the door (e.g. after school club for senior school/ film club)



CHURCH OUTREACH

We are still building up after the devastation of Covid, events include:

- Well attended monthly coffee and cakes (raising funds for our church and other charities) reaching many non-church people.
- Lent lunches are held each year raising funds for our missionary in Ecuador.
- Monthly Sunday lunches at a local pub after the service.
- Joining with All Saints for their Winter and Summer meals and the Men's and Ladies' evenings.
- Service of Light for the bereaved.
- Remembrance service for the village jointly organised with the Guide and Scout movements.
- Hosting a community carol service and carol services for the primary school and pre-school as well as carol concerts for local organisations.
- We welcome bookings for weddings, funerals, baptisms and thanksgiving services.
- We contribute to the Butterley Churches Newsletter and have our own, less frequent one which goes to many non-church going people.
- We are part of Christians Together with our Baptist & Methodist friends.

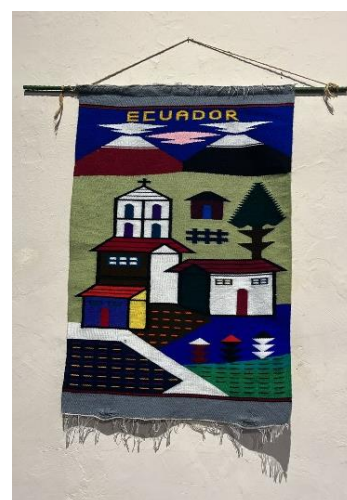

- As Christians Together, we go to Rowthorne Care Home on 3rd Tuesday each month to hold a service, and share together for the Week of Christian Unity, World Day of Prayer and Remembrance Sunday.
- We are making moves to have better links with Swanwick Hall School now that they have a new head. We want to open straight after school finishes, one day a week, to provide a warm space, a safe space and one in which the young people are comfortable to sit and chat, do homework, play games etc over a cup of hot chocolate and the inevitable biscuit.
- At our Wednesday morning service recently, we discussed ways of linking with our baptism families and are planning to introduce occasional services to which the children, their families and godparents are specifically invited. We are also looking at how to provide a next-step for them.
- In addition, we hope to soon restart the short monthly 'Toddlers and Toast' service which immediately preceded the toddler session. It was very popular before Covid intervened and we really want to maintain the church's link with this group.

VALLEY CiDS

Valley CiDS (Christians involved in Developing Society) is a registered Christian Charity founded by one of the current members of St. Andrew's Church. Based in Swanwick, it supports children, young people and families in schools, churches and the wider community throughout Derbyshire and Nottinghamshire. It operates mainly through a network of 36 'Lighthouse' charity shops, the 'Saltpot' community cafe, 5 Youth Centres, a Men's Shed and a 48-acre farm which is a registered centre for Alternative Education provision. It employs 180 people and is supported by over 300 volunteers.

4.3 THE CHURCH

'We consider that the overall condition of the church remains good and patently well cared for' (Quinquennial Inspection comment 2021).

St. Andrew's was built in 1859 and is a Grade II listed building.

Ours is a well-loved and looked after church with no immediate major work needed. In recent years we have had a new roof, walls plastered, new boilers and heating system and new lighting. We have removed pews from the back of the church to provide a flexible open space.

There are toilets and a kitchen off the entrance porch, an internet connection and sound system and projector and screen within the church. The pipe organ is in good condition and regularly serviced. The churchyard is 'closed' except for the burial of ashes and is partially set out as a wilded area. The possibility of becoming an ECO church would be favoured by many but needs to be further investigated. The church office, which is well-equipped, is in The Old School House across the road from the church.



4.4 CHURCH ACCOUNTS

Balance at 31.12.2023

General Account	£4,770
Designated Account	£23,986
Restricted	£26,506
Total Funds	£55,262

Our parish share for 2024 is £32,518 and by the end of the year we fully expect to have paid our full contribution.

5. SAINT MATTHEW'S CHURCH, PENTRICH

5.1 OUR FELLOWSHIP

Our worship is of a traditional liturgical style with robed clergy and preferably traditional hymns. We feel that within our group of three churches Saint Matthew's provides an important alternative to the style of Saint Andrew's and All Saints.

Our normal pattern of worship is Holy Communion on the first and second Sundays of the month using Common Worship booklets. Members of our congregation attend joint services at Swanwick on the remaining Sundays apart from Easter, Harvest, Advent and Christmas when services in Saint Matthew's are well attended by the villagers, sometimes with up to 100 people.



The music for services is now provided by a digital three manual organ with pedal board which has a superb sound. The old unplayable pipe organ is still in situ. Ongoing discussions with the Diocese are taking place to remove it to create a more adaptable space in the church.

Attendance at services varies between 10 and 18. Our great weakness is the ageing and diminishing congregation composed largely of people who are physically limited in what they can do. Because of these limitations, several annual village events, which were suspended during the Covid regulations, have never been revived.

The Pentrich PCC consists of one Churchwarden, a licensed Reader, the Treasurer and one other.

5.2 MISSION AND MINISTRY

The parish of Saint Matthew's, which historically included Ripley and its outlying communities, now consists of the village of Pentrich, which is set on a hill in a rural setting containing several working farms and the hamlets of Hammersmith and Lower Hartshay, a total of about 260 dwellings. There are a couple of pubs but no shops in the parish.



There is a riding stable in Pentrich, a small business estate in Hammersmith and a small brewery. The original houses in Hammersmith were built in 1820 for the workers of Butterley Company, which is now closed.

Although there is little outreach to families with children in the parish, people in the village are always willing to help the church with cleaning and running a rota for opening the church daily during the summer months. Once a year about 45 pupils

from Saint John's School, Ripley, with their teachers, visit the church to learn about its history and about the Pentrich revolution.

Walkers on the public footpath that passes through the graveyard appreciate being able to sit in the beauty and peace of the church and enjoy sitting on the seat in the Garden of Remembrance looking over the Glebe and the miles of tranquil countryside towards Crich and beyond.

Our strength lies in the dedication of the people who faithfully give their time to running the church, and in the friends we have in the group of churches, who come to our aid whenever needed.

Our church is struggling and a continual decline could inevitably lead to closure. We will do our utmost to ensure this will not happen: so we are aiming to develop a closer relationship with the village and parish.

To this end we are in the process of writing a letter which will be delivered to all the houses, asking them how they feel about the church, what they would like to see and whether anyone would be prepared to help out with jobs such as cleaning, simple repair or helping to arrange flowers. We are thinking about restarting the Snowdrop Tea – the history of which goes back a hundred years or more, and we are considering how we could help/welcome walkers more by working alongside the people of Pentrich.

Until the churchyard is closed, the cost of cutting the grass is becoming prohibitive. This has led us to consider not mowing the area behind the church and turning this into a wilded area. Discussions are starting with the local wildlife group with the possibility of enlisting the primary school children in Swanwick to chart progress.

5.3 THE CHURCH



Saint Matthew's Church, a Grade 1 listed building, is of Norman origin, having been consecrated in 1150, but it does contain some stones with Saxon carvings. It has several very beautiful stained-glass windows that are a major feature of its Grade 1 citation. There is seating, mainly on fixed pews, for a maximum of 150 people. Its beauty and long history make it a popular wedding venue.

The belltower houses six bells, the oldest cast in 1525 and the newest in 1993. These are rung before services on the first Sunday in the month and practices are fortnightly. There is an efficient sound system with a loop in the church. Facilities are very limited, there being a composting toilet in the shed behind the bell tower and the only water supply in the building is a cold tap in the vestry with no sink or drain.

The Village Hall is owned by the church and leased to a management committee. It is in constant use.

The large churchyard is now full, and we are in the process of applying for a faculty to close it and transfer its upkeep to the appropriate local council.



5.4. CHURCH ACCOUNT BALANCES

Unrestricted “free” reserves: £1,760

Unrestricted (designated): £43,450

Restricted: £1,130

Our parish share for 2024 is £9,534.

Over the past few years we have paid £500 per month to contribute as much as we can, which this year would have been nearly 2/3 of the total. However, our finances are now in a poor state and so from this autumn we have had to reduce our contribution to a token £50 per month.

6. ADDITIONAL INFORMATION

6.1 OCCASIONAL OFFICES

For the year 2023.

SERVICE	RIPLEY	SWANWICK	PENTRICH
Weddings	3	1	1
Renewal of wedding vows	1	-	-
Baptisms	16	2	-
Thanksgivings	1	2	1
Funerals in Church	22	10	2
Funerals at the Crematorium only	3	-	-
Burial of ashes	-	1	3

6.2 THE VICARAGE



26 Mount Pleasant, Ripley, DE5 3DX

The vicarage was built in the 1950's and was later extended to provide a five-bedroom detached house. There is a family bathroom upstairs. Downstairs comprises a spacious lounge, dining room, study, living kitchen, utility room, cloakroom/toilet.
(Plans for the vicarage are available on request.)

Outside there is a single garage and lawns to the front and rear of the house. There is a small field adjacent to the house which is owned by the Diocese.

It is a light spacious property with rural views from the rear towards the Parish of Pentrich and it is pleasantly situated on a quiet road some four hundred metres from the church.



6.3 CONTACTS

SECONDARY SCHOOLS

- **The Ripley Academy and Sixth Form**
www.ripleyacademy.org
- **Swanwick Hall School**
A secondary school (11 – 18) serving Swanwick and the surrounding area.
www.swanwickhall.ttct.co.uk
- **Swanwick School and Sports College (Special School KS1 – KS4)**
www.swanwicksportscollege.co.uk

There are other secondary schools available in the area and other options for post 16 further education at a number of colleges and schools.

PRIMARY SCHOOLS

- **St John's C of E Primary School & Nursery, Ripley. (The church has 3 Foundation Governor representation)**
www.st-johns.derbyshire.sch.uk
- **Lons Infant School, Ripley**
www.lons.derbyshire.sch.uk
- **Ripley Infant and Junior School, Ripley** (They are on the same site)
www.ripley-jun.derbyshire.sch.uk and
www.ripley-inf.derbyshire.sch.uk
- **Street Lane Primary School, Ripley**
www.streetlane.derbyshire.sch.uk
- **Swanwick Primary School, Swanwick**
www.swanwick.derbyshire.sch.uk

NURSERY PROVISION

- **Ripley Nursery School**
www.ripley-nur.derbyshire.sch.uk
- **Nursery provision at St John's C of E Primary School, Ripley**
www.st-johns.derbyshire.sch.uk
- **Swanwick Pre-school** – funded by parents
www.swanwickpreschool.co.uk

DIOCESE CONTACT

The Venerable Karen Hamblin, Archdeacon of East Derbyshire Diocese of Derby.
01332 388699 and 07496 823404
karen.hamblin@derby.anglican.org

CHURCH ADMINISTRATOR

Helen Bridger – All Saints Church Office, Moseley Street, Ripley, Derby, DE5 3DA.
The office is open from 9.30 a.m. to 12.30 p.m. Tuesday to Friday.
Telephone no. 01773 570011. Email: enquiries@allsaintsripley.org.uk

LINKS

- Derby Church House: www.derby.anglican.org
- Amber Valley Borough Council: www.ambervalley.gov.uk
- Valley CIDS: www.valleycids.co.uk